

Instructions for Using the *BioEcoSS* TubeTrap

1) Setting the door to trap

This is very easy and can be accomplished with one hand with a little practice. The door (a) is held in the closed position by the door catch (b). Depress this slightly with your middle finger and you can then push the door down with your forefinger (c). The trip mechanism is set automatically when the door is flat against the tunnel floor.

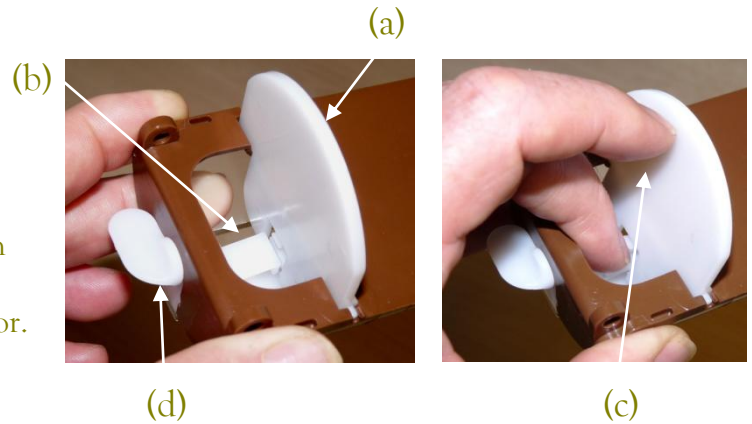

2) Locking the door for pre-baiting

When you have set the trap as explained in (1), you can set the trap for pre-baiting by twisting the door lock (d) to the vertical position. Unlike another well-known trap, this gives a very clear visual indication that the door is locked.

3) Opening the transparent tunnel cover

To adjust the trip weight or insert a name tag you need to remove the transparent tunnel cover. This is held in place with six snap-fit buttons. Simply slide a fingernail along the edge of the cover to release the buttons (e) and then pull it off from the front with the tab beneath the door lock (f).

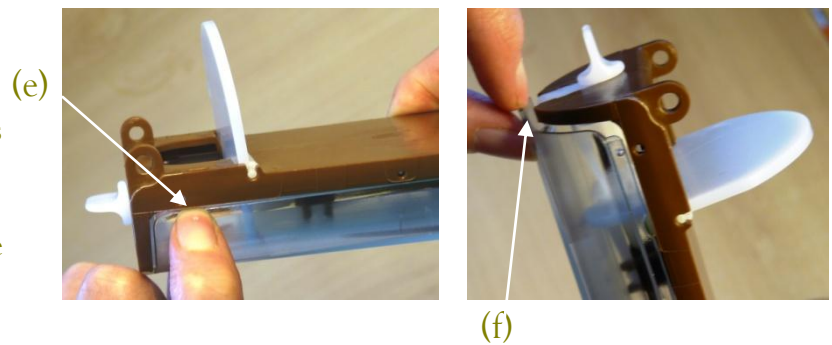

4) Adjusting the trip weight

The trip weight is controlled by the position of the purple elastic spring. To increase the trip weight, slide the spring along the two pins towards the treadle (g). This provides a greater resistance to a force applied on the treadle, *i.e.* the weight of the animal. To reduce the trip weight slide the spring away from the treadle (h). The mechanism has been designed to allow a minimum trip weight of 3g to be set easily, although it is possible to set it even lighter.

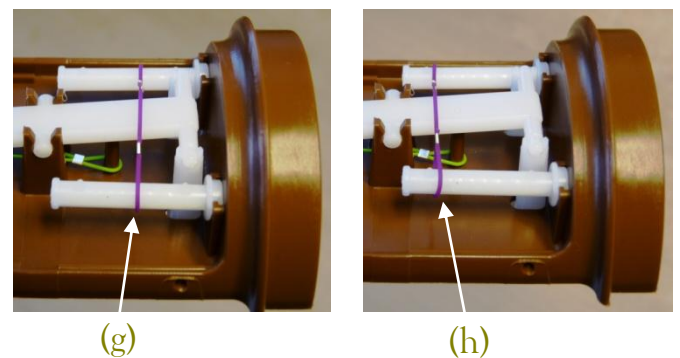

Tip! When the trip weight is very light, you can set the trap *in situ* more easily by turning it onto its side.

5) Stabilising the trap on sloping ground

If you are setting the trap on sloping ground, or if you just want it to be more stable, you can flick the swivelling foot through 90° to be at right-angles to the tunnel.

6) Creating a name / number tag

You can print small cards with trap numbers or codes and other details such as a contact or just a note that this is a live-catch trap for scientific research which does not harm animals. Slide this into the name tag holder on the inside of the transparent tunnel cover.

(Contact *BioEcoSS Ltd.* for a proforma for printing these cards.)